

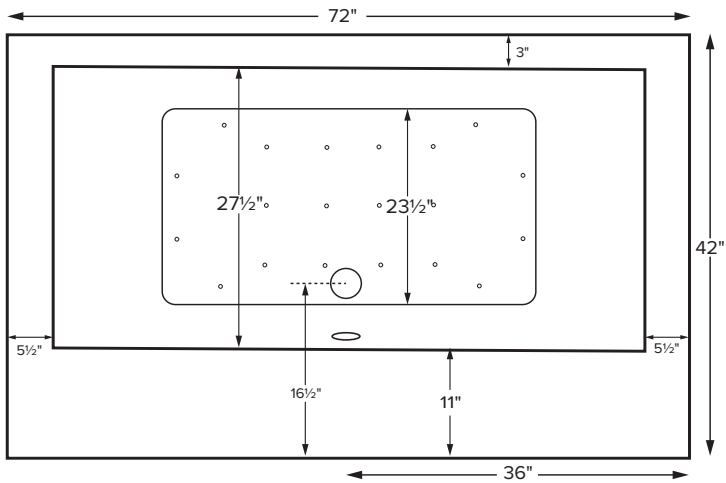

Available as a freestanding model or finished on 1, 2 or 3 sides for various installation applications.

Metro 1  
with Sculpted Finish®

MODEL 83A		
72" x 42" x 23"		
FREESTANDING or ALCOVE <i>Not recommended as a tub/shower combination</i> 100 gal to overflow		
Acrylic CXL®	DoloMatte®	
180 lbs / 82 kg	<SOAKER>	203 lbs / 92 kg
Filling this tub to the maximum may require an above average size or dedicated water heater.		



Features a flat 11" deck surface on the drain side for mounting faucetry. Drain kit sold separately.  
Shown as Air Bath

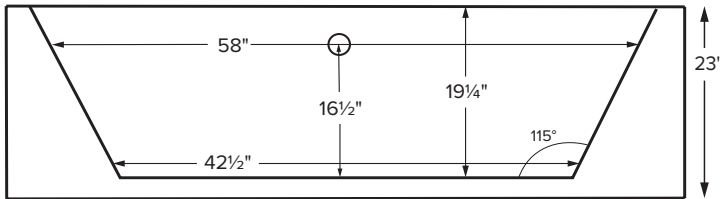

ELECTRICAL COMPONENTS & SPECIFICATIONS

Hydrotherapy Package	Components Included	GFCI/110V
Microbubbles	Microbubbles pump	1-15 amp
Air Massage	heated blower	1-15 amp
Microbubbles with Air	Microbubbles pump, heated blower	1-20 amp
Air Massage Elite	heated blower, chromatherapy	1-15 amp
Microbubbles with Air Elite	Microbubbles pump, heated blower, chromatherapy	2-15 amp

Electrical requirements may change with the addition of optional therapy components. See specific option details or installation information.  
CSA Certified C/US; B45.5/1APMO ANSI Z124.1 and ANSI 112.19.7

See the Installation & Operation Manual for more details.  
MTI's Customer Service: Monday-Friday 8am-6pm EST  
800-783-8827 or service@mtibaths.com

IMPORTANT ORDERING & INSTALLATION INFORMATION

- Before ordering or installing, please consider future access to equipment.
- Unless ordering Sculpted Finish on 4 sides, please include a diagram specifying which sides will need to be finished, along with location of optional tile flange(s).
- Drain is not included with this tub model.
- When ordering an air bath, the air blower must be remote mounted.
- Microbubbles system components must be installed on a non-Sculpted Finish side. Components will extend beyond the perimeter of the tub. Call MTI for specific details regarding the desired installation before placing the order.
- Radiance placed on floor locations will affect placement of air jets.
- Hydrotherapy equipment may ship loose for remote installation. See package content on the following page for details. Specifications and configurations are subject to change without notice.
- All tubs are compliant with ASTM C 1028-07 coefficient of friction. DoloMatte meets ANSI A137.1/A326.3 coefficient of friction and AS HB198:2014 slip tests.

• Options and accessories may be packaged inside the tub crate. Always check packaging before discarding.  
• All product measurements are  $\pm 1/2"$ .  
• Specifications and configurations are subject to change without notice.  
• Measurements herein supersede all others published prior to publication date below.

CSA # MTDS-83A

CSA # MTDS-83D

©2025 by MTI Baths, Inc. Modification Rights Reserved

For more information on hydrotherapy packages  
please visit: [mtibaths.com/wellness/](https://mtibaths.com/wellness/)

**Metro 1**  
with Sculpted Finish®  
MODEL 83A  
72" x 42" x 23"

Hydrotherapy Packages	Package Contents	Sculpted Finish Sides	Acrylic CXL®		DoloMatte®	
			Part #	MSRP	Part #	MSRP
Soaker	Soaking bath - no jets, pre-leveled foam base	4-sides sculpted	<b>S83A4</b>	<b>\$9,350</b>	<b>S83D4</b>	<b>\$10,515</b>
		3-sides sculpted	<b>S83A3</b>	<b>\$8,655</b>	<b>S83D3</b>	<b>\$9,675</b>
		2-sides sculpted	<b>S83A2</b>	<b>\$6,995</b>	<b>S83D2</b>	<b>\$7,870</b>
		1-side sculpted	<b>S83A1</b>	<b>\$6,590</b>	<b>S83D1</b>	<b>\$7,320</b>
Microbubbles	1 infusion port, microbubbles pump, pre-leveled foam base	4-sides sculpted	n/a	n/a	n/a	n/a
		3-sides sculpted	<b>M83A3</b>	<b>\$11,890</b>	<b>M83D3</b>	<b>\$12,910</b>
		2-sides sculpted	<b>M83A2</b>	<b>\$10,225</b>	<b>M83D2</b>	<b>\$11,105</b>
		1-side sculpted	<b>M83A1</b>	<b>\$9,825</b>	<b>M83D1</b>	<b>\$10,555</b>
Air Massage	20 air jets, heated air blower, pre-leveled foam base	4-sides sculpted	<b>AST83A4</b>	<b>\$12,905</b>	<b>AST83D4</b>	<b>\$14,070</b>
		3-sides sculpted	<b>AST83A3</b>	<b>\$12,210</b>	<b>AST83D3</b>	<b>\$13,230</b>
		2-sides sculpted	<b>AST83A2</b>	<b>\$10,545</b>	<b>AST83D2</b>	<b>\$11,425</b>
		1-side sculpted	<b>AST83A1</b>	<b>\$10,145</b>	<b>AST83D1</b>	<b>\$10,875</b>
Air Massage Elite	30 air jets, heated air blower, Chromatherapy LED lighting, Spa Mode, pre-leveled foam base	4-sides sculpted	<b>AE83A4</b>	<b>\$14,755</b>	<b>AE83D4</b>	<b>\$15,920</b>
		3-sides sculpted	<b>AE83A3</b>	<b>\$14,060</b>	<b>AE83D3</b>	<b>\$15,080</b>
		2-sides sculpted	<b>AE83A2</b>	<b>\$12,395</b>	<b>AE83D2</b>	<b>\$13,270</b>
		1-side sculpted	<b>AE83A1</b>	<b>\$11,990</b>	<b>AE83D1</b>	<b>\$12,720</b>
Microbubbles with Air Massage	1 infusion port, microbubbles pump, 20 air jets, heated air blower, pre-leveled foam base	4-sides sculpted	n/a	n/a	n/a	n/a
		3-sides sculpted	<b>ASTM83A3</b>	<b>\$14,860</b>	<b>ASTM83D3</b>	<b>\$15,875</b>
		2-sides sculpted	<b>ASTM83A2</b>	<b>\$13,195</b>	<b>ASTM83D2</b>	<b>\$14,070</b>
		1-side sculpted	<b>ASTM83A1</b>	<b>\$12,790</b>	<b>ASTM83D1</b>	<b>\$13,520</b>
Microbubbles with Air Massage Elite	1 infusion port, microbubbles pump, 30 air jets, heated air blower, Chromatherapy LED lighting, Spa Mode, pre-leveled foam base	4-sides sculpted	n/a	n/a	n/a	n/a
		3-sides sculpted	<b>AEM83A3</b>	<b>\$16,610</b>	<b>AEM83D3</b>	<b>\$17,630</b>
		2-sides sculpted	<b>AEM83A2</b>	<b>\$14,945</b>	<b>AEM83D2</b>	<b>\$15,825</b>
		1-side sculpted	<b>AEM83A1</b>	<b>\$14,545</b>	<b>AEM83D1</b>	<b>\$15,270</b>

**Microbubbles system components must be installed on a non-Sculpted Finish® side.**

**Components will extend beyond the perimeter of the tub. Call MTI for specific details regarding the desired installation before placing order.**

For more customized applications, additional hydrotherapies may possibly be integrated in Sculpted Finish® tubs, depending on the types of therapy and the installation application. Visit [mtibaths.com](https://mtibaths.com) or call MTI at 800.783.8827.

## RECOMMENDED SENSORY THERAPIES

### Chromatherapy

(LE) **\$880** underwater lighting  
2 LED lights included

### Audiotherapy

(STEREOBT) **\$1,535** 2 transducers  
with bluetooth and amplifier  
(BTREMOTE) **\$660** bluetooth remote

(STEREOH202) **\$1,740** 4 transducers  
amplifier not included

### Thermaltherapy

(RAD100) **\$1,760** Radiance®  
2 heated zones included  
Zones may be specified  
on Metro tub deck.



For more information on options and accessories go to Acrylic Tub Options on mtibaths.com

Metro 1 with Sculpted Finish®  
MODEL 83A

Options <i>Must be ordered at time of purchase.</i>	
<b>Standard Color</b> White (CWH) gloss Acrylic CXL, matte DoloMatte	
<b>Textured, Slip-Resistant Bottom</b> (TXTBTM) <b>\$115</b> DoloMatte® exceeds ANSI A137.1/A326.3 and AS HB198 slip tests.	
<b>Ozonator</b> (OZONE) <b>\$565</b> <i>Cannot be added to soakers or airbaths without Microbubbles system.</i>	
<b>Virtual Spout</b> high-flow integrated tub filler (FPMJ) <b>\$500</b> <i>Must be located on same side as tub deck. Specify location when ordering.</i>	
Installation Options <i>Must be ordered at time of purchase.</i>	
<b>Tile Flange</b> Factory Installed rigid ABS 1 Side (TFK1) <b>\$190</b> 2 Sides (TFK2) <b>\$205</b> 3 Sides (TFK3) <b>\$220</b> Field Install Kit (TFKNI) <b>\$205</b> Includes rigid ABS & adhesive	<b>IMPORTANT:</b> <i>Must specify flange location(s) on order of Factory-Installed Flange.</i>

Accessories	
<b>Pillows</b> from <b>\$200</b>	
<b>Teak Bath Mat</b> (TKMAT3018) <b>\$880</b> <i>Custom sizes also available. Contact MTI for details and pricing.</i>	
<b>Teak Tub Tray</b> Slatted (TK-TRAY1) <b>\$540</b> Solid (TK-TRAY2) <b>\$615</b>	
<b>Floor-Mounted High-Flow Tub Filler</b> Traditional Brushed Nickel (FILLTBN) <b>\$1,885</b>	

Drains & Overflow Kits		<i>Toe Tap Rectangular Overflow must be ordered at time of purchase</i>	
<b>Cable Driven</b>		<b>Toe Tap</b>	
<b>Drain Finishes</b> – PVC Drain Kit		<b>Round Overflow</b> – PVC Drain Kit	
White/Bone/Biscuit (WOCWD) <b>\$485</b>		Chrome (WOTTC) <b>\$420</b>	
Chrome (WOC) <b>\$450</b>		Brushed Nickel (WOTTBN) <b>\$425</b>	
Brushed Nickel (WOCDBN) <b>\$540</b>		Polished Nickel (WOTTPN) <b>\$425</b>	
Polished Nickel (WOCDPN) <b>\$595</b>		Special Finishes* (WOTTSF) <b>\$1,260</b>	
Oil-Rubbed Bronze† (WOCBOR) <b>\$610</b>		<b>Round Overflow</b> – Solid Brass Drain	
Polished Brass (WOCDBR) <b>\$760</b>		Chrome (WOTTSBC) <b>\$895</b>	
Special Finishes* (WOCDSF) <b>\$1,250</b>		Brushed Nickel (WOTTSBBN) <b>\$895</b>	
<i>MTI does not offer a brass body cable drain kit.</i>		Polished Nickel (WOTTSBPN) <b>\$895</b>	
<b>Lift &amp; Turn</b>		<b>Rectangular Overflow</b> – PVC Drain Kit	
<b>Drain Finishes</b> – PVC Drain Kit		Chrome (WOTRC) <b>\$520</b>	
Chrome (WOC) <b>\$205</b>		Brushed Nickel (WOTRBN) <b>\$475</b>	
White (WOW) <b>\$270</b>		White (WOTRW) <b>\$580</b>	
Brushed Nickel (WOB) <b>\$335</b>			

Slim-Line Overflow with Toe Tap Drain <i>Must be ordered at time of purchase.</i>	
<ul style="list-style-type: none"> <li>Low profile overflow is factory installed</li> <li>Overflow measures 4.5" x 1"</li> <li>Provides a deeper soak</li> <li>Not available for commercial applications</li> </ul>	<b>Slim-Line Overflow with Toe Tap Drain</b> PVC Drain Chrome (SLOT) <b>\$550</b> Brushed Nickel (SLOTBN) <b>\$585</b> Polished Nickel (SLOTBN) <b>\$615</b> White (SLOTW) <b>\$475</b>

Slim-Line Overflow with Toe Tap Drain	
Solid Brass Drain	
Chrome (SLOTSBC) <b>\$1,025</b>	
Brushed Nickel (SLOTSBBN) <b>\$1,030</b>	
Polished Nickel (SLOTSBPN) <b>\$1,030</b>	
White (SLOTSBW) <b>\$1,065</b>	



Optional Slim-Line overflow

† MTI has selected an oil-rubbed bronze finish that is compatible with Delta and many other manufacturers. To ensure best match, order as a Special Finish and submit a sample.  
\* Allow 2-4 weeks lead time for Special Finishes. Send sample for best match.