

Alissa

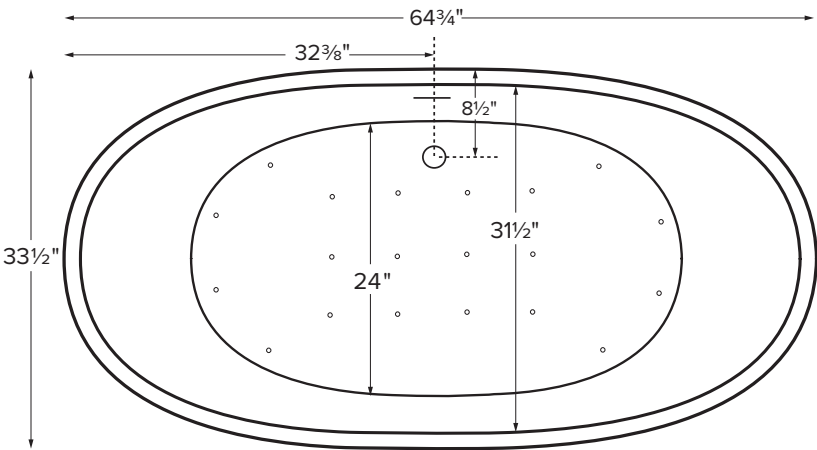

Features an integrated overflow.

MODEL 231
64.75" x 33.5" x 20.75"/22"
FREESTANDING 90 gal to overflow
SculptureStone®
260 lbs / 118 kg soaker 290 lbs / 132 kg airbath
May also be undermounted. Must specify on order. Not recommended as a tub / shower combination. Filling this tub to the maximum may require an above average size or dedicated water heater.



Shown above as an Air Bath.

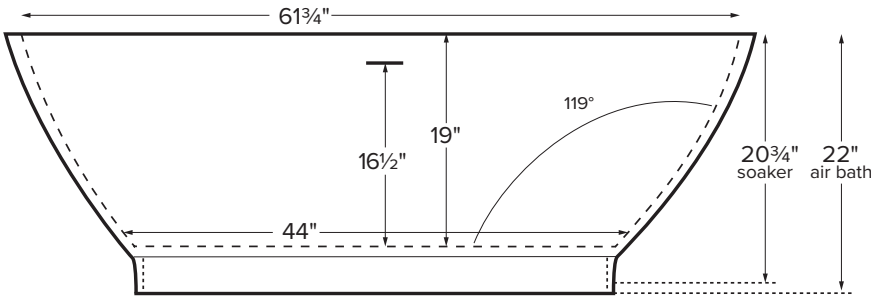

ELECTRICAL COMPONENTS & SPECIFICATIONS

Required Electrical Service - 110 Volt

Hydrotherapy Package	Components Included	GFCI
Air Massage	heated blower	1-15 amp

Electrical requirements may change with the addition of optional therapy components.
See specific option details or installation information.
CSA Certified C/US; ANSI Z124.1 and ANSI 112.19.7 and ANSI 112.19.7

See the Installation & Operation Manual for more details.
MTI's Customer Service: Monday-Friday 8am-6pm EST
800-783-8827 or service@mtibaths.com

IMPORTANT ORDERING & INSTALLATION INFORMATION

- Before ordering or installing, please consider future access to equipment.
- Includes an integrated overflow with toe tap drain in chrome finish. May be specified without an overflow (see local codes before ordering without an overflow).
- Air baths require job site preparation for remote installation of the blower and required check valve. Check valve must be installed higher than the rim of the tub.
- Waterproof remote control included with air bath. Keypad shipped loose may be remote mounted on nearby surface/wall.
- Faucet valves cannot be mounted on this tub model.

- Before discarding tub crate, check for accessories that may be packaged inside.
- All product measurements are $\pm 1/2"$.
- Specifications and configurations are subject to change without notice.
- Measurements herein supersede all others published prior to publication date below.



For more information on options and accessories go to SculptureStone® Tubs Options on mtibaths.com

Alissa

MODEL #: 231

64.75" x 33.5" x 20.75"/22"

- Blower & required check valve for airbath must be remote mounted.
- Check valve must be installed higher than the rim of the tub.
- See the Installation & Operation Manual for more details.

Hydrotherapy	Package Contents	Part #	Finish	MSRP
Soaker	Soaking bath - no jets. Includes an integrated slotted overflow with a toe-tap drain kit.	S231	soft matte	\$8,300
		S231GL	hand-polished gloss	\$9,385
Air Bath	20 air jets, heated air blower, keypad, waterproof remote control, integrated slotted overflow with a toe-tap drain kit.	AST231	soft matte	\$13,420
		AST231GL	hand-polished gloss	\$14,505

Options *Must be ordered at time of purchase*

Quick Ship (QSPRI2) **\$1,025** reduces lead time
Please call for availability

Standard Color White
Biscuit Color Upgrade (SSBI) **\$310**

Additional material colors available for projects only. Please call MTI.

Exterior Color \$1,760 (SSCOLTG) Gloss Finish (SSCOLTM) Matte Finish
Must specify color code:

Sapphire Blue (SB), Blue Lagoon (BL), Terracotta (TC),
Onyx (OX), Stratus Gray (TG), Stormgray (SG)

Check mtibaths.com for current lead time

Accessories

Teak Bath Mat (TKMAT3018) **\$815** Measures 30" x 17.5" x 1"
Custom sizes also available. Contact MTI for details.

SculptureStone® Tub Tray

No Stemware Holder (SSTRAY1) **\$340** matte (SSTRAY1GL) gloss **\$340**
With Stemware Holder (SSTRAY2) **\$450** matte (SSTRAY2GL) gloss **\$450**

Order with tub for best color match

Teak Tub Tray

Slatted (TK-TRAY1) **\$500** Solid (TK-TRAY2) **\$570**
Order with tub for best fit

Boutique Accessories

Packaging / Handling Fee Applies

SculptureStone® Bathroom Table (TABLE) **\$825** matte finish
(TABLEGL) **\$1,235** gloss finish

Order with tub for best color match

SculptureStone® Standard Faucet Stand

Small - 3-hole capacity

14¼" w x 20½" h

Matte (STAND) **\$725**

Gloss (STANDGL) **\$1,135**

Large - 5-hole capacity

22" w x 21½" h

Matte (STANDL) **\$855**

Gloss (STANDLGL) **\$1,265**

SculptureStone® Premium Faucet Stand

15" w x 39" h

Matte (SSFSR3915MT) **\$2,365**

Gloss (SSFSR3915GL) **\$2,720**

10" w x 39" h

Matte (SSFSR3910MT) **\$2,135**

Gloss (SSFSR3910GL) **\$2,525**

20" w x 23" h

Matte (SSFSR2320MT) **\$1,930**

Gloss (SSFSR2320GL) **\$2,315**

15" w x 23" h

Matte (SSFSR2315MT) **\$1,825**

Gloss (SSFSR2315GL) **\$2,180**

SculptureStone® Premium Component Stand

20" l x 22.5" h

Matte (SSPX1MT) **\$2,000**

Gloss (SSPX1GL) **\$2,640**

Compatible with select tub models.

Go to www.mtibaths.com

Drains & Overflow Kits *Must be ordered at time of purchase*

Toe Tap Drain Cover Finishes

PVC drain - Chrome included

+\$50 upcharge Br. Nickel (WIOBN), Pol. Nickel (WIOPN)

+\$85 upcharge Matte Black (WIOMB)

+\$105 upcharge Oil-Rubbed Bronze* (WIOOR)

+\$640 upcharge Special Finish* (WIOSF)

Send finish sample to MTI Baths for best match.

Toe Tap SculptureStone® Drain Cover Finishes

Upgrade is in lieu of standard chrome to tap drain cover.

White only

+\$90 upcharge Matte Finish (SSWIOMT)

+\$110 upcharge Gloss Finish (SSWIOGL)

Brass Tailpiece (WIOBS) **\$85** in addition to finish charge listed above

Quick Drain Kit (WOQ) **\$460**

* MTI has selected an oil-rubbed bronze finish that is compatible with Delta and many other manufacturers. To ensure best match, order as a Special Finish and submit a sample.

CSA # MTCT-231

©2023 by MTI Baths, Inc. Modification Rights Reserved

* Allow 2-4 weeks lead time for Special Finishes.
Send sample for best match.

