

Adrian

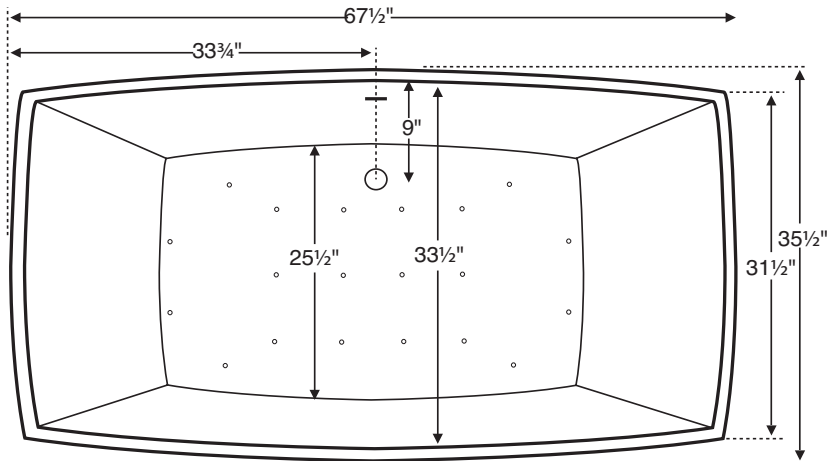

Features an integrated overflow.

MODEL 218
67.5" x 35.5" x 22.5"/24"
FREESTANDING 124 gal to overflow
SculptureStone®
300 lbs / 136 kg soaker 330 lbs / 150 kg airbath
May also be undermounted. Must specify on order. Not recommended as a tub / shower combination.  Filling this tub to the maximum may require an above average size or dedicated water heater.



Shown above as an Air Bath.

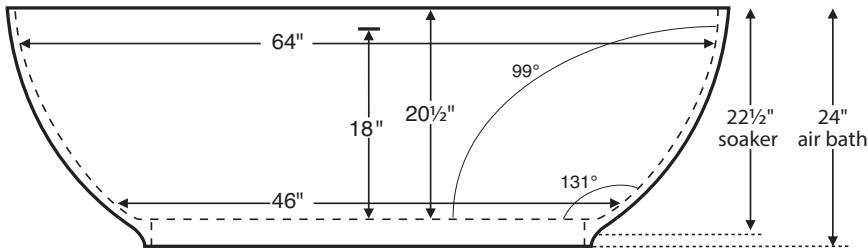

ELECTRICAL COMPONENTS & SPECIFICATIONS		
Required Electrical Service - 110 Volt		
Hydrotherapy Package	Components Included	GFCI
Air Massage	heated blower	1-15 amp
Electrical requirements may change with the addition of optional therapy components. See specific option details or installation information. CSA Certified C/US; ANSI Z124.1 and ANSI 112.19.7 and ANSI 112.19.7		

See the Installation & Operation Manual for more details.  
MTI's Customer Service: Monday-Friday 8am-6pm EST  
800-783-8827 or service@mtibaths.com

- IMPORTANT ORDERING & INSTALLATION INFORMATION**
- Before ordering or installing, please consider future access to equipment.
  - Includes an integrated overflow with toe tap drain in chrome finish. May be specified without an overflow (see local codes before ordering without an overflow).
  - Air baths require job site preparation for remote installation of the blower and required check valve. Check valve must be installed higher than the rim of the tub.
  - Waterproof remote control included with air bath. Keypad shipped loose may be remote mounted on nearby surface/wall.
  - Faucet valves cannot be mounted on this tub model.

• Before discarding tub crate, check for accessories that may be packaged inside.  
• All product measurements are ±1/2".  
• Specifications and configurations are subject to change without notice.  
• Measurements herein supersede all others published prior to publication date below.

For more information on options and accessories go to SculptureStone® Tubs Options on mtibaths.com

Adrian

MODEL #: 218

67.5" x 35.5" x 22.5"/24"

- Blower & required check valve for airbath must be remote mounted.
- Check valve must be installed higher than the rim of the tub.
- See the Installation & Operation Manual for more details.

Hydrotherapy	Package Contents	Part #	Finish	MSRP
Soaker	Soaking bath - no jets. Includes an integrated slotted overflow with a toe-tap drain kit.	S218	soft matte	\$8,570
		S218GL	hand-polished gloss	\$9,655
Air Bath	20 air jets, heated air blower, keypad, waterproof remote control, integrated slotted overflow with a toe-tap drain kit.	AST218	soft matte	\$13,690
		AST218GL	hand-polished gloss	\$14,775

### Options *Must be ordered at time of purchase*

**Quick Ship** (QSPRI2) **\$1,025** reduces lead time  
*Please call for availability*

**Standard Color** White  
**Biscuit Color Upgrade** (SSBI) **\$310**

*Additional material colors available for projects only. Please call MTI.*

**Exterior Color \$1,760** (SSCOLTG) Gloss Finish (SSCOLTM) Matte Finish  
Must specify color code:

Sapphire Blue (SB), Blue Lagoon (BL), Terracotta (TC),  
Onyx (OX), Stratus Gray (TG), Stormgray (SG)

[Check mtibaths.com for current lead time](http://Check mtibaths.com for current lead time)

### Accessories

**Teak Bath Mat** (TKMAT3018) **\$815** Measures 30" x 17.5" x 1"  
*Custom sizes also available. Contact MTI for details.*

#### SculptureStone® Tub Tray

No Stemware Holder (SSTRAY1) **\$340** matte (SSTRAY1GL) gloss **\$340**  
With Stemware Holder (SSTRAY2) **\$450** matte (SSTRAY2GL) gloss **\$450**

*Order with tub for best color match*

#### Teak Tub Tray

Slatted (TK-TRAY1) **\$500** Solid (TK-TRAY2) **\$570**

*Order with tub for best fit*

### Boutique Accessories

Packaging / Handling Fee Applies

**SculptureStone® Bathroom Table** (TABLE) **\$825** matte finish  
(TABLEGL) **\$1,235** gloss finish

*Order with tub for best color match*

#### SculptureStone® Standard Faucet Stand

Small - 3-hole capacity

**14¼" w x 20½" h**

Matte (STAND) **\$725**

Gloss (STANDGL) **\$1,135**

Large - 5-hole capacity

**22" w x 21½" h**

Matte (STANDL) **\$855**

Gloss (STANDLGL) **\$1,265**

#### SculptureStone® Premium Faucet Stand

**15" w x 39" h**

Matte (SSFSR3915MT) **\$2,365**

Gloss (SSFSR3915GL) **\$2,720**

**10" w x 39" h**

Matte (SSFSR3910MT) **\$2,135**

Gloss (SSFSR3910GL) **\$2,525**

**20" w x 23" h**

Matte (SSFSR2320MT) **\$1,930**

Gloss (SSFSR2320GL) **\$2,315**

**15" w x 23" h**

Matte (SSFSR2315MT) **\$1,825**

Gloss (SSFSR2315GL) **\$2,180**

### Drains & Overflow Kits *Must be ordered at time of purchase*

#### Toe Tap Drain Cover Finishes

PVC drain - Chrome included

**+\$50** upcharge Br. Nickel (WIOBN), Pol. Nickel (WIOPN)

**+\$85** upcharge Matte Black (WIOBM)

**+\$105** upcharge Oil-Rubbed Bronze\* (WIOOR)

**+\$640** upcharge Special Finish\* (WIOSF)

*Send finish sample to MTI Baths for best match.*

#### Toe Tap SculptureStone® Drain Cover Finishes

Upgrade is in lieu of standard chrome to tap drain cover.

White only

**+\$90** upcharge Matte Finish (SSWIOMT)

**+\$110** upcharge Gloss Finish (SSWIOGL)

**Brass Tailpiece** (WIOBS) **\$85** in addition to finish charge listed above

**Quick Drain Kit** (WOQ) **\$460**

\* MTI has selected an oil-rubbed bronze finish that is compatible with Delta and many other manufacturers. To ensure best match, order as a Special Finish and submit a sample.

CSA # MTCT- 218

©2023 by MTI Baths, Inc. Modification Rights Reserved

\* Allow 2-4 weeks lead time for Special Finishes.  
Send sample for best match.

