

Laney 2

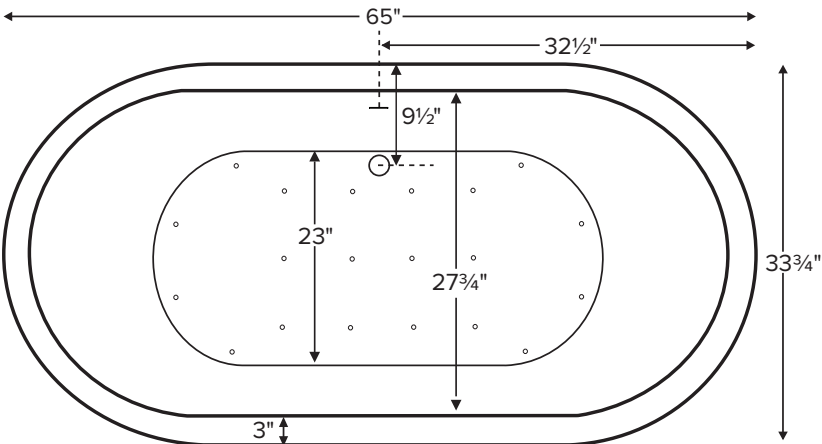

Features an integrated overflow.

MODEL 208		
65" x 33.75" x 23.5"		
FREESTANDING 70 gal to overflow		
Acrylic CXL®		DoloMatte®
140 lbs / 64 kg	<SOAKER>	158 lbs / 72 kg
Filling this tub to the maximum may require an above average size or dedicated water heater.		



Requires use of a wall-mounted or freestanding tub filler.
Shown with Air Massage Package.

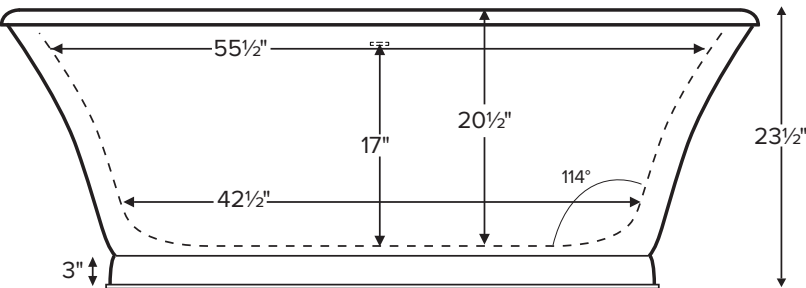
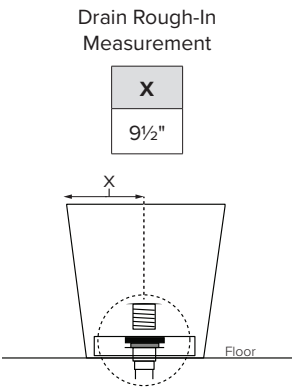

ELECTRICAL COMPONENTS & SPECIFICATIONS

Hydrotherapy Package	Components Included	110V GFCI
Air Massage	heated blower	1-15 amp
Air Massage Elite	heated blower, chromatherapy	1-15 amp
Electrical requirements may change with the addition of optional therapy components. See specific option details or installation information. CSA Certified C/US; B45.5/IAPMO ANSI Z124.1 and ANSI 112.19.7		

See the Installation & Operation Manual for more details.
MTI's Customer Service: Monday-Friday 8am-6pm EST
800-783-8827 or service@mtibaths.com

- Before discarding tub packaging, check for accessories that may be packaged inside.
- All product measurements are ±1/2".
- Specifications and configurations are subject to change without notice.
- Measurements herein supersede all others published prior to publication date below.

IMPORTANT ORDERING & INSTALLATION INFORMATION:

- Before ordering or installing, please consider future access to equipment.
- No access panel. Tub features slotted integrated overflow with toe tap drain.
- Air baths require job site preparations for remote mounting the blower and required check valve. Check valve must be installed higher than the rim of the tub.
- Hydrotherapy equipment may ship loose for remote installation depending on tub model. See package content on the following page for details.
- Radiance placed on floor locations will affect placement of air jets.
- Faucet valves cannot be installed on this tub model.
- All tubs are in accordance with CSA B45.5/IAPMO Z124 standard and compliant with ASTM C 1028-07 coefficient of friction. DoloMatte meets ANSI A137.1/A326.3 coefficient of friction and AS HB198:2014 pendulum slip resistance testing.



- Airbath blower ships loose for remote installation on site.
- See the Installation & Operation Manual for more details.

Laney 2

MODEL 208

65" x 33.75" x 23.5"

Hydrotherapy Packages	Package Contents	Acrylic CXL®		DoloMatte®	
		Part #	MSRP	Part #	MSRP
Soaker	Soaking bath - no jets; includes a pre-leveled foam base. Integrated slotted overflow with toe-tap drain in chrome.	S208	\$6,525	S208DM	\$7,245
Air Massage	20 air jets, heated air blower, pre-leveled foam base. Blower and control boxes must be remote located. Integrated slotted overflow with toe-tap drain in chrome.	AST208	\$9,810	AST208DM	\$10,530
Air Massage Elite	30 air jets, heated air blower, Chromatherapy LED lighting, Spa Mode, pre-leveled foam base. Blower and control boxes must be remote located. Integrated slotted overflow with toe-tap drain in chrome.	AE208	\$11,520	AE208DM	\$12,240

RECOMMENDED SENSORY THERAPIES

Chromatherapy
(LE) **\$800** underwater lighting
2 LED lights included

Audiotherapy
(STEREOBT) **\$1,390** 2 transducers
with bluetooth and amplifier
(BTREMOTE) **\$600** bluetooth remote

(STEREOH202) **\$1,575** 4 transducers
amplifier not included

Thermaltherapy
(RAD100) **\$1,595** Radiance®
2 heated zones included

Options *Must be ordered at time of purchase*

Standard Colors White (CWH) DoloMatte available in matte white only. Biscuit (CBS) Not available for DoloMatte.
Quick Ship reduces lead time (QSPRI) \$430 <i>Please call for availability</i>
Textured Bottom (TXTBTM) Acrylic CXL® only \$105 DoloMatte® exceeds ANSI A137.1/A326.3 and AS HB198 slip tests.

Accessories

Pillows from \$180		
Teak Bath Mat (TKMAT3018) \$815 <i>Custom sizes also available. Contact MTI for details and pricing.</i>		
Floor-Mounted High-Flow Tub Filler Traditional Brushed Nickel (FILLTBN) \$1,745		
Faucet Stand SculptureStone® Standard <table><tr><td>Small 3-hole capacity 14¼" w x 21¾" h Matte (STAND) \$725</td><td>Large 5-hole capacity 22" w x 21¾" h Matte (STANDL) \$855</td></tr></table> +\$430 gloss finish upcharge (SSGLOSSENK)	Small 3-hole capacity 14¼" w x 21¾" h Matte (STAND) \$725	Large 5-hole capacity 22" w x 21¾" h Matte (STANDL) \$855
Small 3-hole capacity 14¼" w x 21¾" h Matte (STAND) \$725	Large 5-hole capacity 22" w x 21¾" h Matte (STANDL) \$855	

Drains & Overflow Kits *Must be ordered at time of purchase*

Integrated Overflow with Toe Tap <table><tr><td>Slotted Overflow PVC drain - Chrome (SLOTIOC) included</td></tr><tr><td>Finish Upcharge White (SLOTIOWHU) \$65 Brushed Nickel (SLOTIOBNU) \$65 Polished Nickel (SLOTIOPNU) \$105</td></tr></table>	Slotted Overflow PVC drain - Chrome (SLOTIOC) included	Finish Upcharge White (SLOTIOWHU) \$65 Brushed Nickel (SLOTIOBNU) \$65 Polished Nickel (SLOTIOPNU) \$105	Round Overflow Chrome (RIOCI) may substitute slotted overflow
Slotted Overflow PVC drain - Chrome (SLOTIOC) included			
Finish Upcharge White (SLOTIOWHU) \$65 Brushed Nickel (SLOTIOBNU) \$65 Polished Nickel (SLOTIOPNU) \$105			
	Finish Upcharge White (RIOWH) \$120 Brushed Nickel (RIOBN) \$120 Polished Nickel (RIOPN) \$120		
	Brass Tailpiece (WIOBS) \$85 <i>May be ordered separately</i>		