



Features an integrated overflow.

Boutique Collection Tubs

Maddux

MODEL 162
60" x 32" x 20.5"
FREESTANDING 63 gal to overflow
SculptureStone®
450 lbs / 204 kg soaker 480 lbs / 218 kg airbath
May also be undermounted. Must specify on order. Not recommended as a tub / shower combination. Filling this tub to the maximum may require an above average size or dedicated water heater.

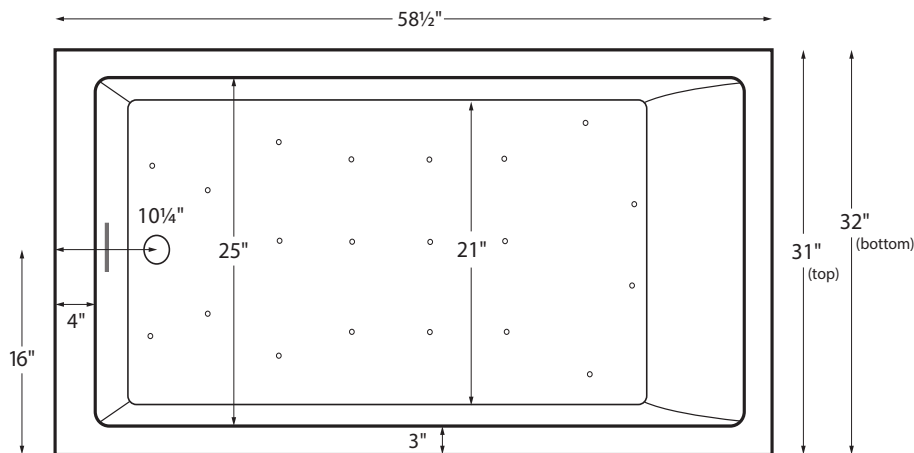

Shown above as an Air Bath.

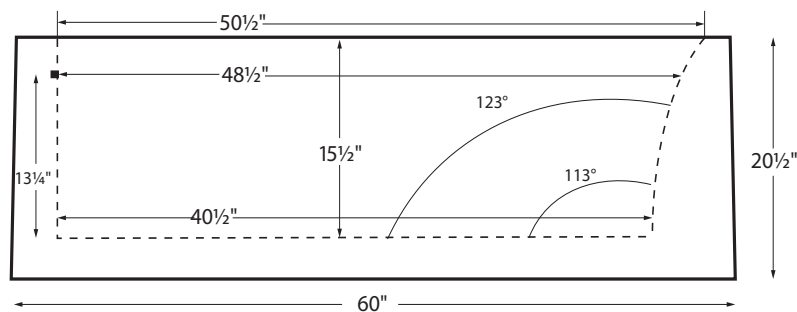

ELECTRICAL COMPONENTS & SPECIFICATIONS

Required Electrical Service - 110 Volt

Hydrotherapy Package	Components Included	GFCI
Air Massage	heated blower	1-15 amp

Electrical requirements may change with the addition of optional therapy components.
See specific option details or installation information.
CSA Certified C/US; ANSI Z124.1 and ANSI 112.19.7 and ANSI 112.19.7

See the Installation & Operation Manual for more details.

MTI's Customer Service: Monday-Friday 8am-6pm EST

800-783-8827 or service@mtibaths.com

IMPORTANT ORDERING & INSTALLATION INFORMATION

- Before ordering or installing, please consider future access to equipment.
- Comes standard as freestanding version. May be ordered with 1, 2 or 3 sides for alcove or other installation types.
- Optional factory-installed tile flange available to ensure watertight seal for alcove or other installation types. Must specify left- or right-hand drain on order.
- Includes an integrated overflow with toe tap drain in chrome finish. May be specified without an overflow (see local codes before ordering without an overflow).
- Air baths require job site preparation for remote installation of the blower and required check valve. Check valve must be installed higher than the rim of the tub.
- Waterproof remote control included with air bath. Keypad shipped loose may be remote mounted on nearby surface/wall.
- Faucet valves cannot be mounted on this tub model.

- Before discarding tub crate, check for accessories that may be packaged inside.
- All product measurements are $\pm 1/2$ ".
- Specifications and configurations are subject to change without notice.
- Measurements herein supersede all others published prior to publication date below.

CSA # MTCT-162

©2023 by MTI Baths, Inc. Modification Rights Reserved

1 of 2



Rev. 09 12 2023

For more information on options and accessories go to SculptureStone® Tubs Options on mtibaths.com

Maddux
MODEL #: 162
60" x 32" x 20.5"

- Blower & required check valve for airbath must be remote mounted.
- Check valve must be installed higher than the rim of the tub.
- See the Installation & Operation Manual for more details.

Hydrotherapy	Package Contents	Part #	Finish	MSRP
Soaker	Soaking bath - no jets. Includes an integrated slotted overflow with a toe-tap drain kit.	S162	soft matte	\$10,650
		S162GL	hand-polished gloss	\$11,880
Air Bath	20 air jets, heated air blower, keypad, waterproof remote control integrated slotted overflow with a toe-tap drain kit.	AST162	soft matte	\$15,770
		AST162GL	hand-polished gloss	\$17,000

Options *Must be ordered at time of purchase*

Quick Ship (QSPRI2) **\$1,025** reduces lead time
Please call for availability

Standard Color White
Biscuit Color Upgrade (SSBI) **\$310**
Additional material colors available for projects only. Please call MTI.

Accessories

Teak Bath Mat (TKMAT3018) **\$815** Measures 30" x 17.5" x 1"
Custom sizes also available. Contact MTI for details.

SculptureStone® Tub Tray
No Stemware Holder (SSTRAY1) **\$340** matte (SSTRAY1GL) gloss **\$340**
With Stemware Holder (SSTRAY2) **\$450** matte (SSTRAY2GL) gloss **\$450**
Order with tub for best color match

Teak Tub Tray
Slatted (TK-TRAY1) **\$500** Solid (TK-TRAY2) **\$570**
Order with tub for best fit

Boutique Accessories

Packaging / Handling Fee Applies

SculptureStone® Bathroom Table (TABLE) **\$825** matte finish
(TABLEGL) **\$1,235** gloss finish
Order with tub for best color match

SculptureStone® Standard Faucet Stand

Small - 3-hole capacity 14¼" w x 20½" h	Large - 5-hole capacity 22" w x 21½" h
Matte (STAND) \$725	Matte (STANDL) \$855
Gloss (STANDGL) \$1,135	Gloss (STANDLGL) \$1,265

SculptureStone® Premium Faucet Stand

15" w x 39" h	10" w x 39" h
Matte (SSFSR3915MT) \$2,365	Matte (SSFSR3910MT) \$2,135
Gloss (SSFSR3915GL) \$2,720	Gloss (SSFSR3910GL) \$2,525
20" w x 23" h	15" w x 23" h
Matte (SSFSR2320MT) \$1,930	Matte (SSFSR2315MT) \$1,825
Gloss (SSFSR2320GL) \$2,315	Gloss (SSFSR2315GL) \$2,180

Drains & Overflow Kits *Must be ordered at time of purchase*

Toe Tap Drain Cover Finishes

PVC drain - Chrome included
+**\$50** upcharge Br. Nickel (WIOBN), Pol. Nickel (WIOPN)
+**\$85** upcharge Matte Black (WIOMB)
+**\$105** upcharge Oil-Rubbed Bronze* (WIOOR)
+**\$640** upcharge Special Finish* (WIOSF)
Send finish sample to MTI Baths for best match.

Toe Tap SculptureStone® Drain Cover Finishes

Upgrade is in lieu of standard chrome to tap drain cover.
White only
+**\$90** upcharge Matte Finish (SSWIOMT)
+**\$110** upcharge Gloss Finish (SSWIOGL)

Brass Tailpiece (WIOBS) **\$85** in addition to finish charge listed above
Quick Drain Kit (WOQ) **\$460**

* MTI has selected an oil-rubbed bronze finish that is compatible with Delta and many other manufacturers. To ensure best match, order as a Special Finish and submit a sample.

CSA # MTCT-162

©2023 by MTI Baths, Inc. Modification Rights Reserved

* Allow 2-4 weeks lead time for Special Finishes.
Send sample for best match.

