

MacPherson

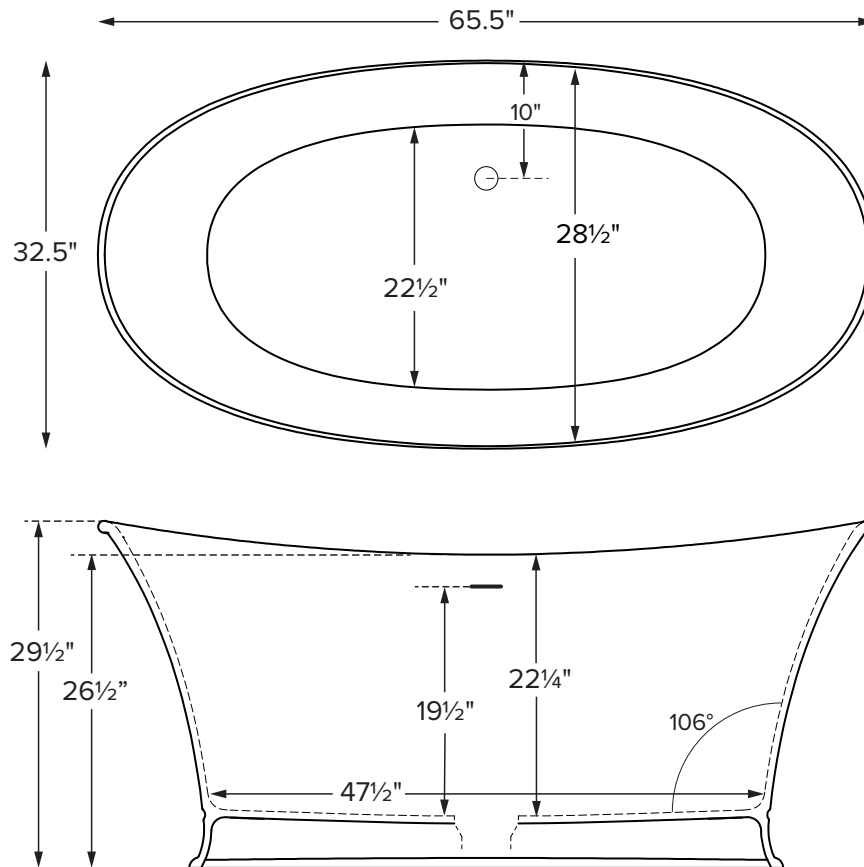

Features an integrated overflow

MODEL 155
65.5" x 32.5" x 26.5"
FREESTANDING 88 gal to overflow
SculptureStone®
260 lbs / 118 kg soaker
Filling this tub to the maximum may require an above average size or dedicated water heater.



ELECTRICAL COMPONENTS & SPECIFICATIONS

Required Electrical Service - 110 Volt

Hydrotherapy Package	Components Included	GFCI
Airbath	heated blower	1-15 amp

Electrical requirements may change with the addition of optional therapy components. See specific option details or installation information.
CSA Certified C/US; ANSI Z124.1 and ANSI 112.19.7 and ANSI 112.19.7

See the Installation & Operation Manual for more details.
MTI Bath's Customer Service: Monday-Friday 8am-6pm EST
800-783-8827 or service@mtibaths.com

IMPORTANT ORDERING & INSTALLATION INFORMATION

- Before ordering or installing, please consider future access to equipment.
- Includes an integrated overflow with toe tap drain in chrome finish. May be specified without an overflow (see local codes before ordering without an overflow).
- Airbaths require job site preparation for remote installation of the blower and required check valve. Check valve must be installed higher than the rim of the tub.
- Waterproof remote control included with airbath. Keypad shipped loose may be remote mounted on nearby surface/wall.
- Faucet valves cannot be mounted on this tub model.

- Before discarding tub crate, check for accessories that may be packaged inside.
- All product measurements are $\pm 1/2"$.
- Specifications and configurations are subject to change without notice.
- Measurements herein supersede all others published prior to publication date below.

CSA # MTCT-155

©2024 by MTI Baths, Inc. Modification Rights Reserved

For more information on options and accessories
go to SculptureStone® Tubs Options on mtibaths.com

MacPherson

MODEL 155

65.5" x 32.5" x 26.5"

- Blower & required check valve for airbath must be remote mounted.
- Check valve must be installed higher than the rim of the tub.
- See the Installation & Operation Manual for more details.

Hydrotherapy	Package Contents	Part #	Finish	MSRP
Soaker	Soaking bath - no jets. Includes an integrated slotted overflow with a toe-tap drain kit.	S155	soft matte	\$9,240
		S155GL	hand-polished gloss	\$10,475
Airbath	20 air jets, heated air blower, keypad, waterproof remote control, integrated slotted overflow with a toe-tap drain kit.	AST155	soft matte	\$14,965
		AST155GL	hand-polished gloss	\$16,195

Options *Must be ordered at time of purchase*

Quick Ship (QSPRI2) **\$1,110** reduces lead time
Please call for availability

Standard Color White
Biscuit Color Upgrade (SSBI) **\$320**
Additional material colors available for projects only. Please call MTI Baths.

Accessories

Teak Bath Mat (TKMAT3018) **\$880** Measures 30" x 17.5" x 1"
Custom sizes also available. Contact MTI Baths for details.

MTI Accessories

Packaging / Handling Fee Applies

SculptureStone® Bathroom Table (TABLE) **\$895** matte finish
(TABLEGL) **\$1,360** gloss finish

Order with tub for best color match

SculptureStone® Standard Faucet Stand

Small - 3-hole capacity 14¼" w x 20½" h	Large - 5-hole capacity 22" w x 21½" h
Matte (STAND) \$780	Matte (STANDL) \$925
Gloss (STANDGL) \$1,250	Gloss (STANDLGL) \$1,390

SculptureStone® Premium Faucet Stand

15" w x 39" h	10" w x 39" h
Matte (SSFSR3915MT) \$2,555	Matte (SSFSR3910MT) \$2,310
Gloss (SSFSR3915GL) \$2,940	Gloss (SSFSR3910GL) \$2,730
20" w x 23" h	15" w x 23" h
Matte (SSFSR2320MT) \$2,090	Matte (SSFSR2315MT) \$1,975
Gloss (SSFSR2320GL) \$2,505	Gloss (SSFSR2315GL) \$2,355

Drains & Overflow Kits *Must be ordered at time of purchase*

Toe Tap Drain Cover Finishes

PVC drain - Chrome included
+\$55 upcharge Br. Nickel (WIOBN), Pol. Nickel (WIOPN)
+\$95 upcharge Matte Black (WIOMB)
+\$115 upcharge Oil-Rubbed Bronze[†] (WIOOR)
+\$695 upcharge Special Finish* (WIOSF)
Send finish sample to MTI Baths for best match.

Toe Tap SculptureStone® Drain Cover Finishes

Upgrade is in lieu of standard chrome to tap drain cover.
White only

+\$100 upcharge Matte Finish (SSWIOMT)
+\$120 upcharge Gloss Finish (SSWIOGL)

Brass Tailpiece (WIOBS) **\$95** in addition to finish charge listed above

Quick Drain Kit (WOQ) **\$510**

[†] MTI Baths has selected an oil-rubbed bronze finish that is compatible with Delta and many other manufacturers. To ensure best match, order as a Special Finish and submit a sample.

CSA # MTCT-155

©2024 by MTI Baths, Inc. Modification Rights Reserved

* Allow 2-4 weeks lead time for Special Finishes.
Send sample for best match.